

FISH LAKE USFS

S92

FISH LAKE

**LOCATION**

LAT 46°19.81'

LONG 115°03.79'

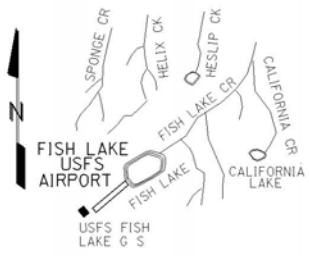

**LAYOUT**

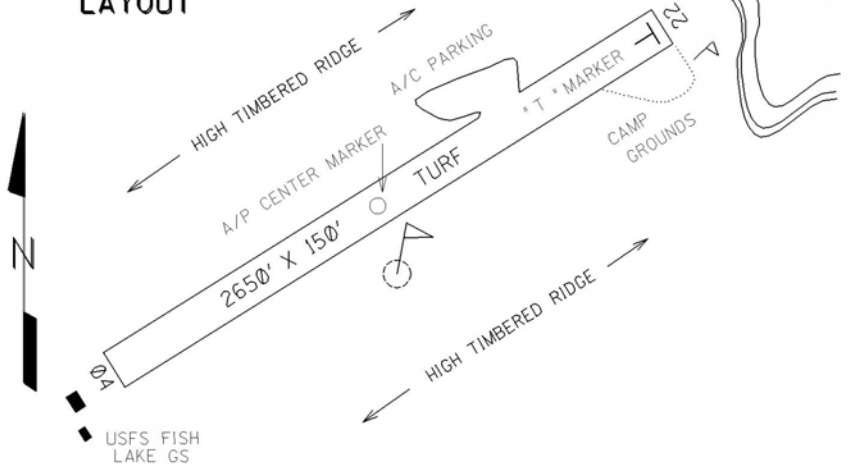

ELEVATION 5646

**LOCATION** ADJACENT W OF FISH LAKE

**FUEL** NO

**VOR** MS0  
**FREQ** 112.8  
**RAD** 212°  
**NM** 54.0

**SERVICES**  
NO

**COMMUNICATIONS** CTAF 122.9

**NAV AIDS** NO

**MANAGER** 208-983-1964

**LIGHTS** NO

**FBO(s)**  
NO

**ATTENDED** NO

**REMARKS** LAND RWY 22, DEPART RWY 04. GO AROUNDS NOT RECOMMENDED  
STEEP RISING TERRAIN OFF WEST END OF RWY. DOWNDRAFTS PREVALENT OVER LAKE.  
RECOMMEND EARLY MORNING AND LATE EVENING OPERATIONS DURING SUMMER MONTHS.  
CAUTION: HIGH DENSITY ALTITUDE AIRPORT. NO WINTER MAINTENANCE. CONTACT  
MANAGER FOR BRIEFING. DO NOT TAXI PAST CONE MARKERS AT END OF RWY 04.